

THE GROVE 

---

# MEETINGS AND EVENTS

---

# THE GROVE

London's inspiring  
country escape.



Set in 300 acres of rolling Hertfordshire countryside just 18 miles from London, our idyllic country estate is the perfect hideaway for a creative event of any size. From the traditional 18th Century Mansion to the contemporary Cedar Suite, The Grove promises 28 bright, beautiful spaces, not forgetting the wonderfully verdant Walled Garden. And with use of up to 215 bedrooms, let your imagination run wild...



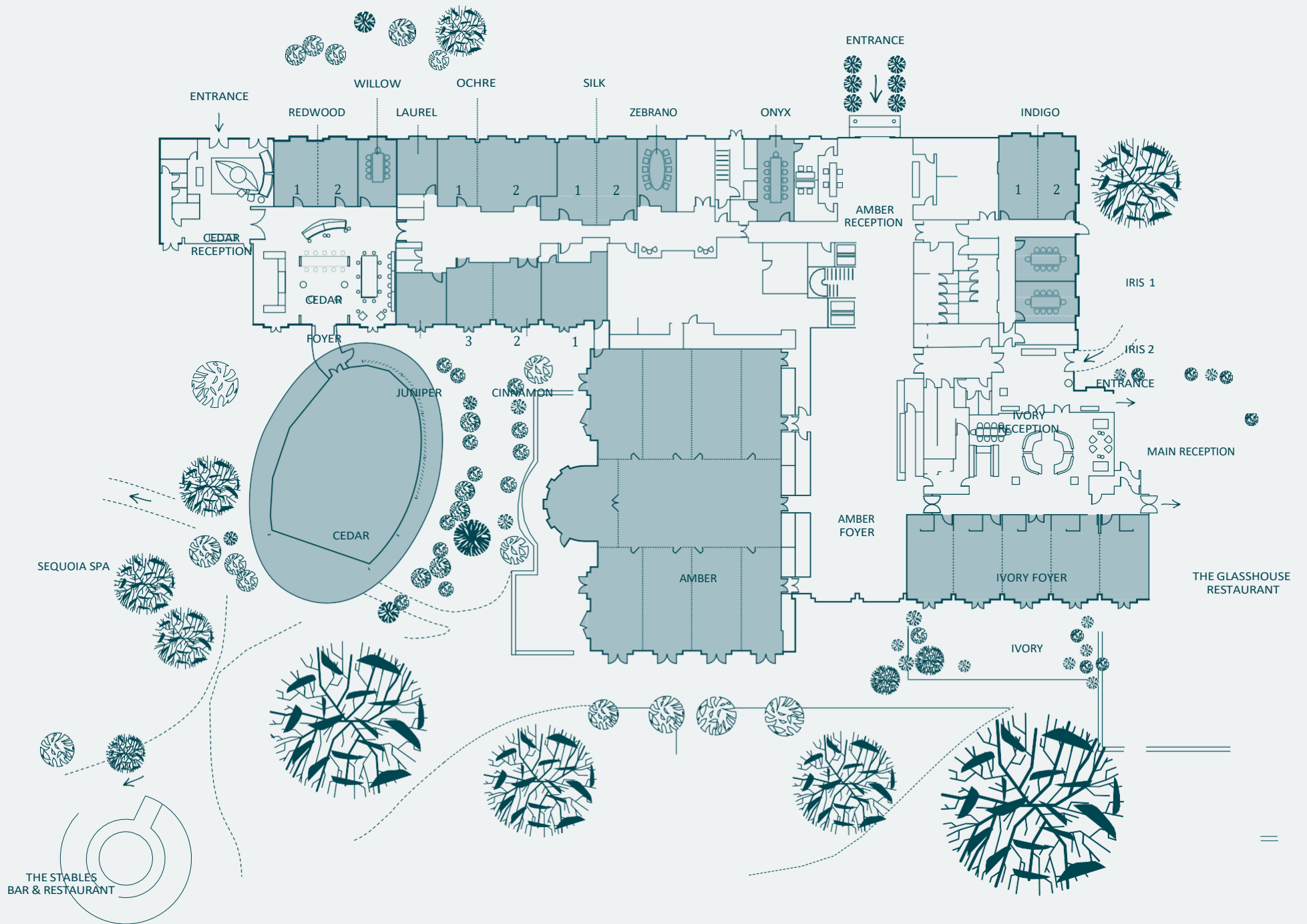

# AMBER

Enjoy a stand out event in the largest of our luxury event spaces.

The Amber Suite is a blank canvas that can be used to host large events or divided into up to nine sections for smaller events, making it the ideal venue for conferences, board meetings, weddings and celebrations. Spanning 520m<sup>2</sup> of space, its dedicated entrance, private foyer and panoramic views make it a spectacular choice for any event.



# Key Features

Ground floor location

Vehicular access area

Dedicated entrance with registration desk

Private reception area with in-built bar

Divisible into 9 rooms

2 drop down screens

In-built PA system

In-built projector in rooms 2/3, 4 & 6/7

2 x 3 phase 63amp separate feed (room 1)

1 x 3 phase 63amp separate feed (room 5)

Pin spotting

Private terrace

## DIMENSIONS

Area	521.5sqm
Height	3.9m to 4.7m
Length	29.56m
Width	17.63m

## SET-UPS

Theatre	450*
Classroom	300*
Boardroom	78
U-shape	78
Cabaret	256
Reception	700
Lunch/Dinner	480
Dinner dance	420
Seated buffet	330
Standing buffet	500
Exhibition	36 stands of 3x2m

\*front projection

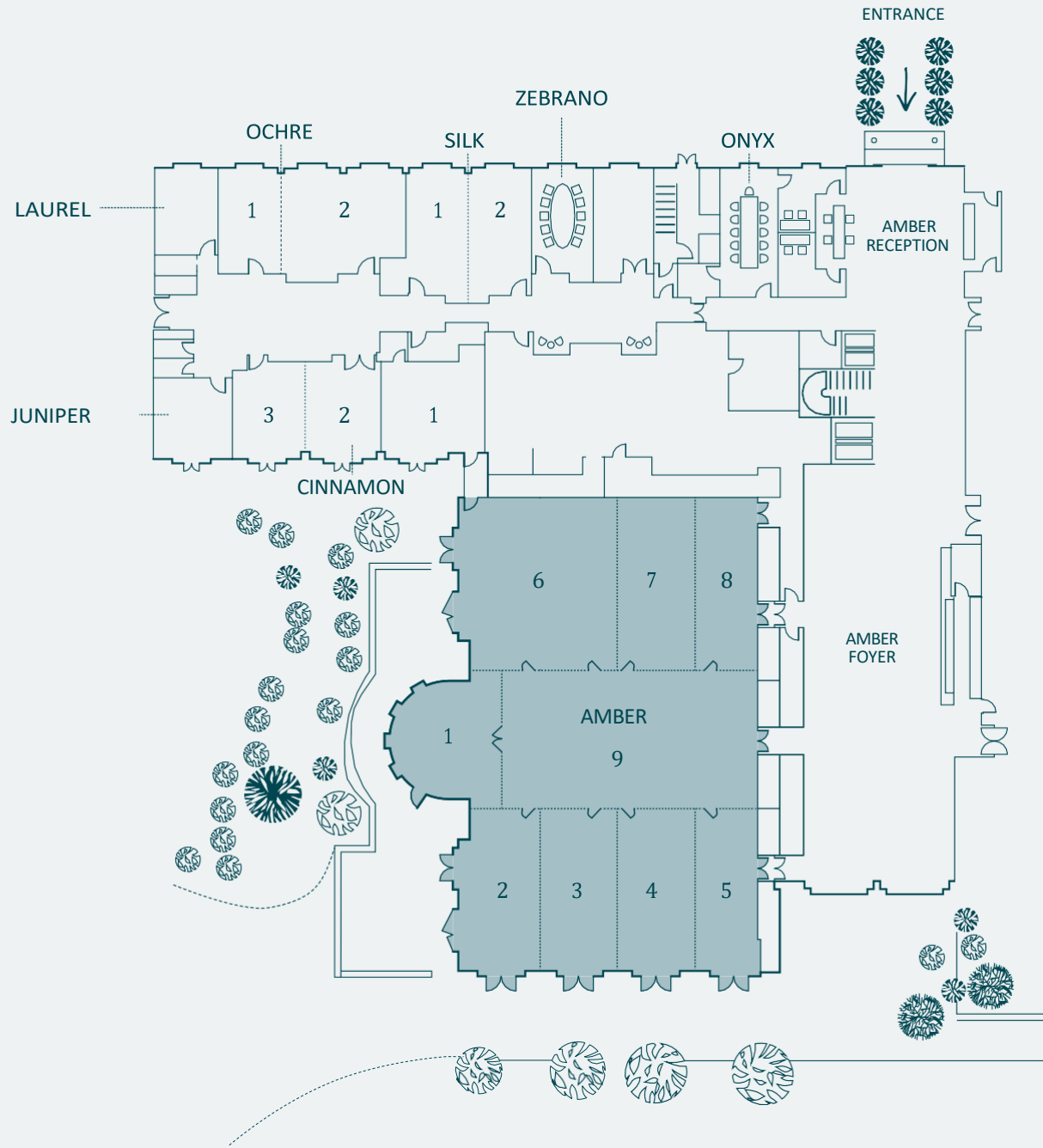

# CEDAR

Our bright and airy Cedar Suite brings the outside in, with its natural sunlight and nature themed decor.

Designed by luxury interiors guru Martin Hulbert, the space offers a 180 degree view over our stunning formal gardens and comes with a private entrance and foyer, as well as three spacious meeting rooms and breakout spaces.

Named after the 200-year-old trees in our grounds, this flexible venue is perfect for meetings, events and lavish private parties.



# Key Features

Ground floor location

Dedicated entrance with registration desk

Private reception area with in-built bar

3 phase power

85 inch LED screen

Data projector and drop down screen

LED lighting and pin spoting

Private terrace

## DIMENSIONS

Area	205.4sqm
Height	3.33m
Length	15.74m
Width	13.05m

## SET-UPS

Theatre	166
Classroom	96
Boardroom	60
U-shape	48
Cabaret	84
Reception	200
Lunch/Dinner	168
Dinner dance	110
Seated buffet	100
Standing buffet	175
Exhibition	17 stands

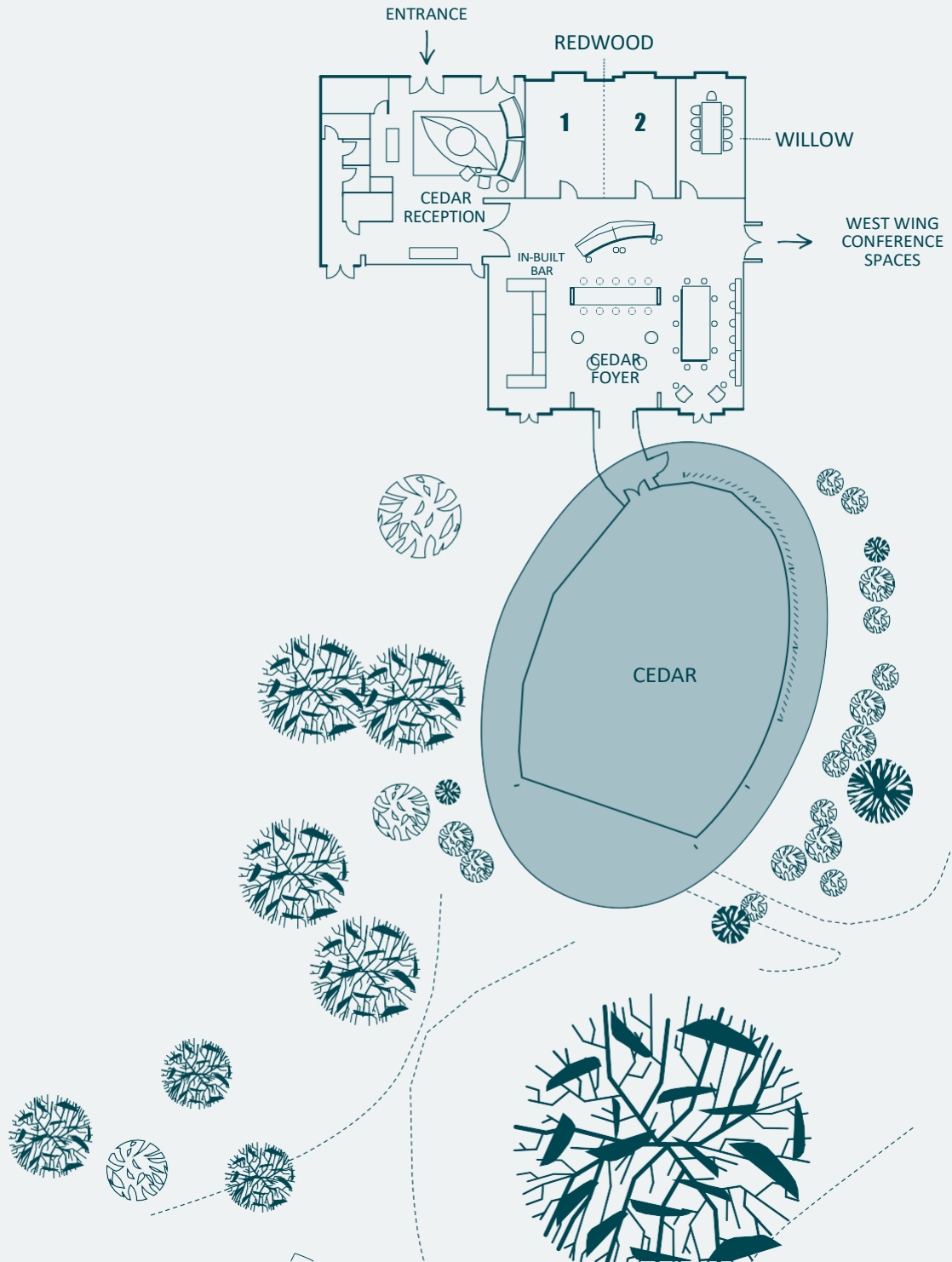

# IVORY

A flexible, contemporary space set at the heart of the hotel.

With a private entrance and terrace, the space is perfect for medium-sized meetings and parties.

Boasting natural daylight and direct access to our formal gardens, these unique function rooms can be broken down into five sections to accommodate smaller groups.



# Key Features

- Ground floor location
- Dedicated entrance with registration desk
- Private reception area with in-built bar
- Divisible into 5 rooms
- LED screens in rooms 1, 2, 4 & 5
- In-built PA system
- 2 drop down screens
- In-room dimmer controls
- Private terrace

## DIMENSIONS

Area	132.24sqm
Height	2.9m to 3.4m
Length	23.2m
Width	5.7m

## SET-UPS

Theatre	120*
Classroom	60*
Boardroom	60
U-shape	64
Cabaret	64
Reception	150
Lunch/Dinner	120
Dinner dance	80
Seated buffet	80
Standing buffet	150
Exhibition	8 stands of 3x2m

\*front projection

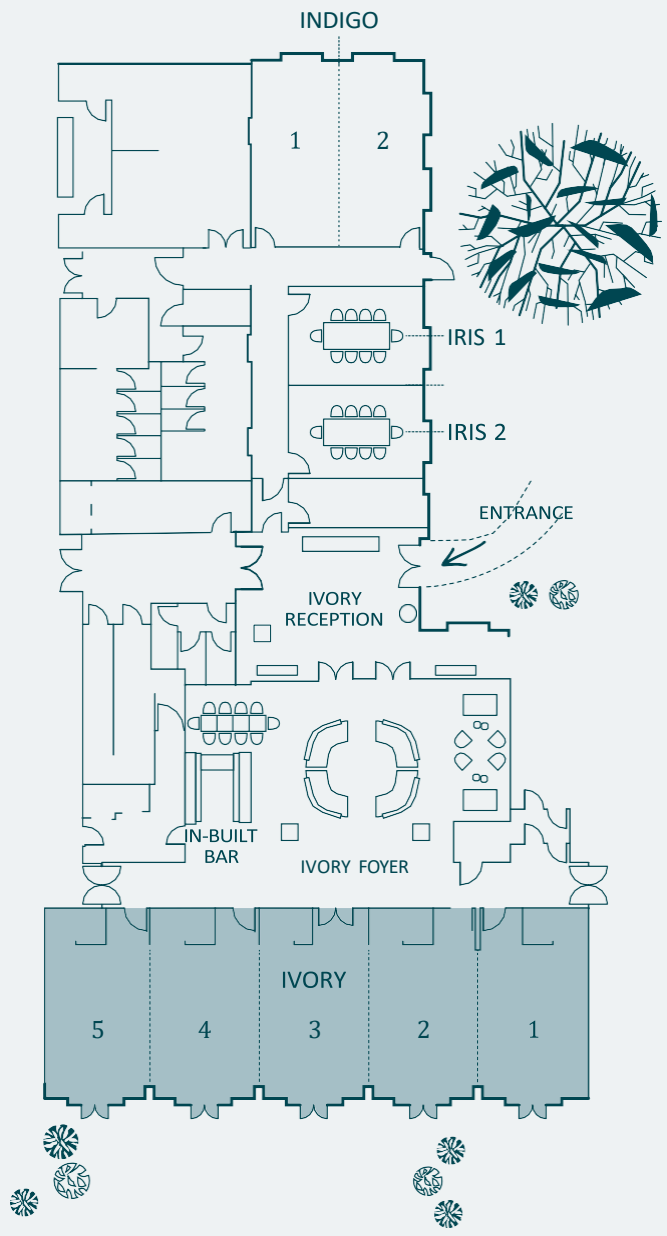

# THE POTTING SHED

A hidden gem, our rustic Potting Shed is located inside our gated Walled Garden.

Situated in our stunning Victorian Walled Garden, the Potting Shed promises a setting unlike any other.

A beautifully restored Victorian glasshouse, the Potting Shed is the perfect mix of shabby chic and a wonderful space for a reception, summer cocktail party or evening barbecue. Its capacity can be increased with the addition of a marquee.



# Key Features



- Ground floor location
- Spectacular glass ceiling
- Private, gated entrance
- 3 phase power
- 4 interlinking rooms
- Views of the Walled Garden
- Outdoor space, suitable for marquee

## DIMENSIONS

Area	247.5sqm
Height	1.7m to 3.4m
Length	55m
Width	4.5m

## SET-UPS

Reception	150
Lunch/Dinner	70
Dinner dance	60
Seated buffet	60
Standing buffet	100

### The Walled Garden

Area	13,048sqm
Length	116.5m
Width	112m

### The Beach

Area	13,048sqm
Length	116.5m
Width	112m

### Croquet Lawn

Area	684sqm
Length	18m
Width	38m

### Tennis Courts

Area	1,120sqm
Length	35m
Width	32m

### Swimming Pool

Length	25m
Width	10m

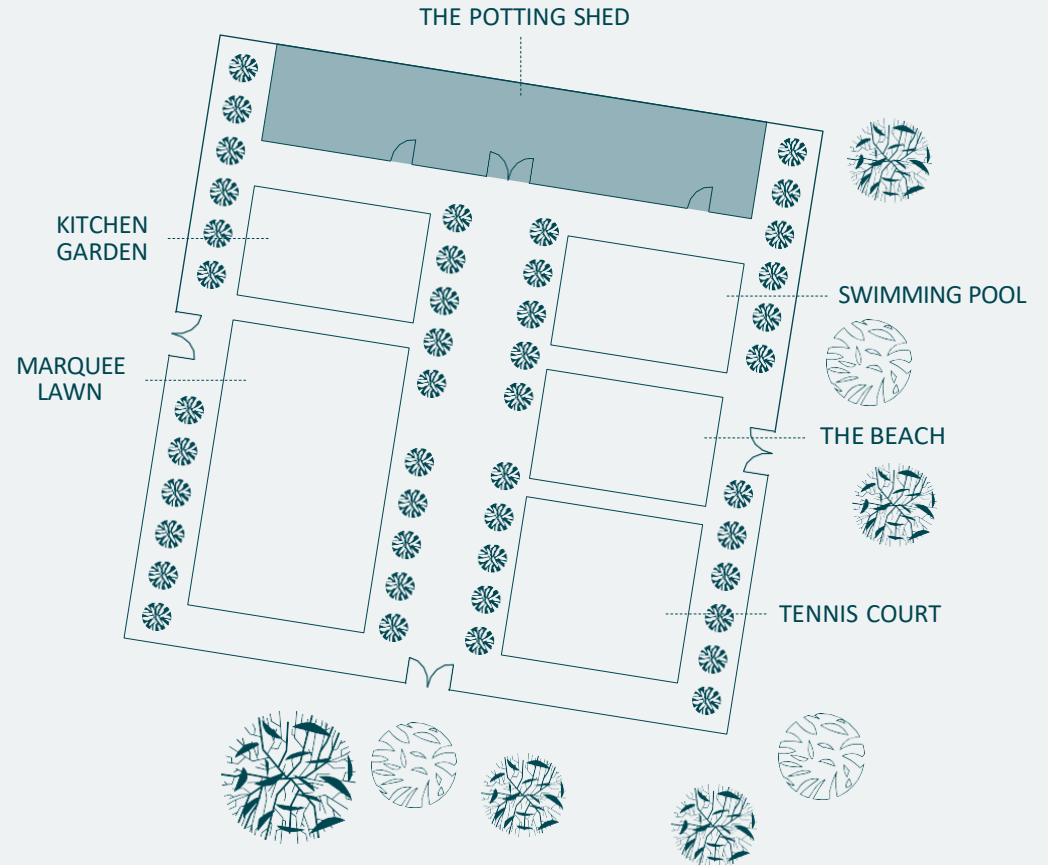

# MANSION

Elegant unique spaces  
for small to medium  
sized events.

With character aplenty, the 18th Century Mansion promises a series of elegant spaces for small to medium sized events. Choose from the Donneraile, Garden Room or Colette's, all of which offer sophisticated decor with panoramic views across the grounds and gardens, perfect for events or celebrations which demand a backdrop that is just a little bit special.



# Key Features



Ground floor location

Grade II listed Mansion

High ceilings

Large windows

Views over the golf course

Private terrace

## DIMENSIONS

	The Garden Room	Donneraile
Area	51.6sqm	60.6sqm
Height	4.3m	4.79m
Length	8.6m	10.1m
Width	6.5m	6.45m

## SET-UPS

Theatre	16	
Boardroom	14	24
U-shape	12	22
Reception	28	28
Lunch/Dinner	28	28
Seated buffet	20	
Standing buffet	30	

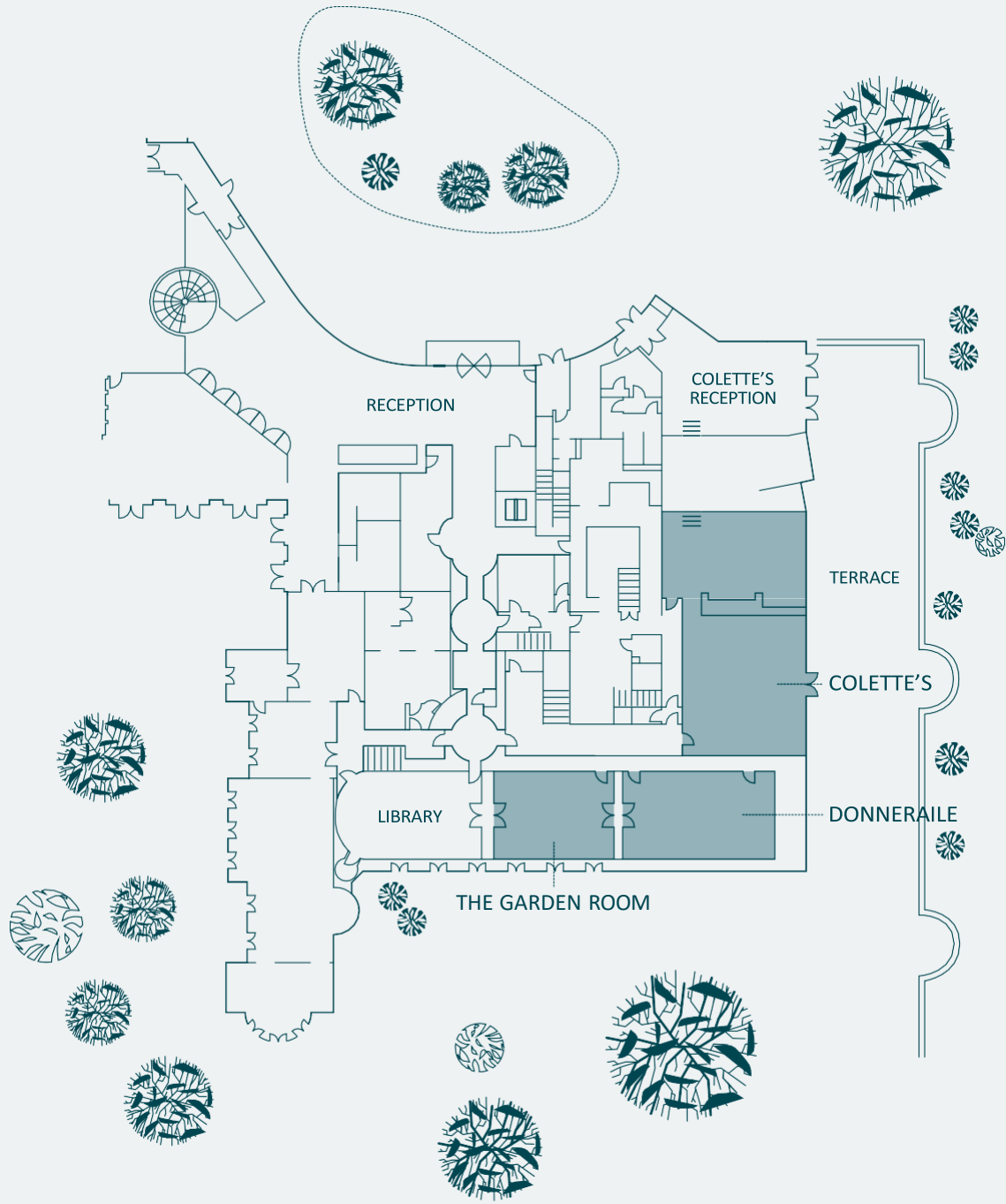

# SMALL MEETING ROOMS

Breakout spaces with  
lots of natural daylight and  
a contemporary design.

Our meeting rooms feature natural daylight,  
boardroom tables and whiteboard walls – perfect  
for creative brainstorming.

Whether it's a private group of executives or a  
break out from a larger conference, we'll make sure  
you have everything you need for your mini meet-  
up. Groups can also use these smaller rooms as  
breakout spaces during a larger event.



# CINNAMON



With its private entrance, terrace and access to the gardens, the contemporary Cinnamon room is also a fantastic choice for small to medium-sized private events.

## KEY FEATURES

Ground floor location

Divisible into 3 rooms

LED screen

In-built projector

Tungsten Halogen lights

In-room dimmer controls

## DIMENSIONS

Area	92.34sqm
Height	2.9m to 3.4m
Length	17.1m
Width	5.4m

## SET-UPS

Theatre	100*
Classroom	42*
Boardroom	40
U-shape	35
Cabaret	48*
Reception	120
Lunch/Dinner	70
Dinner dance	50
Seated buffet	50
Standing buffet	100
Exhibition	6 stands of 3x2m

\*front projection

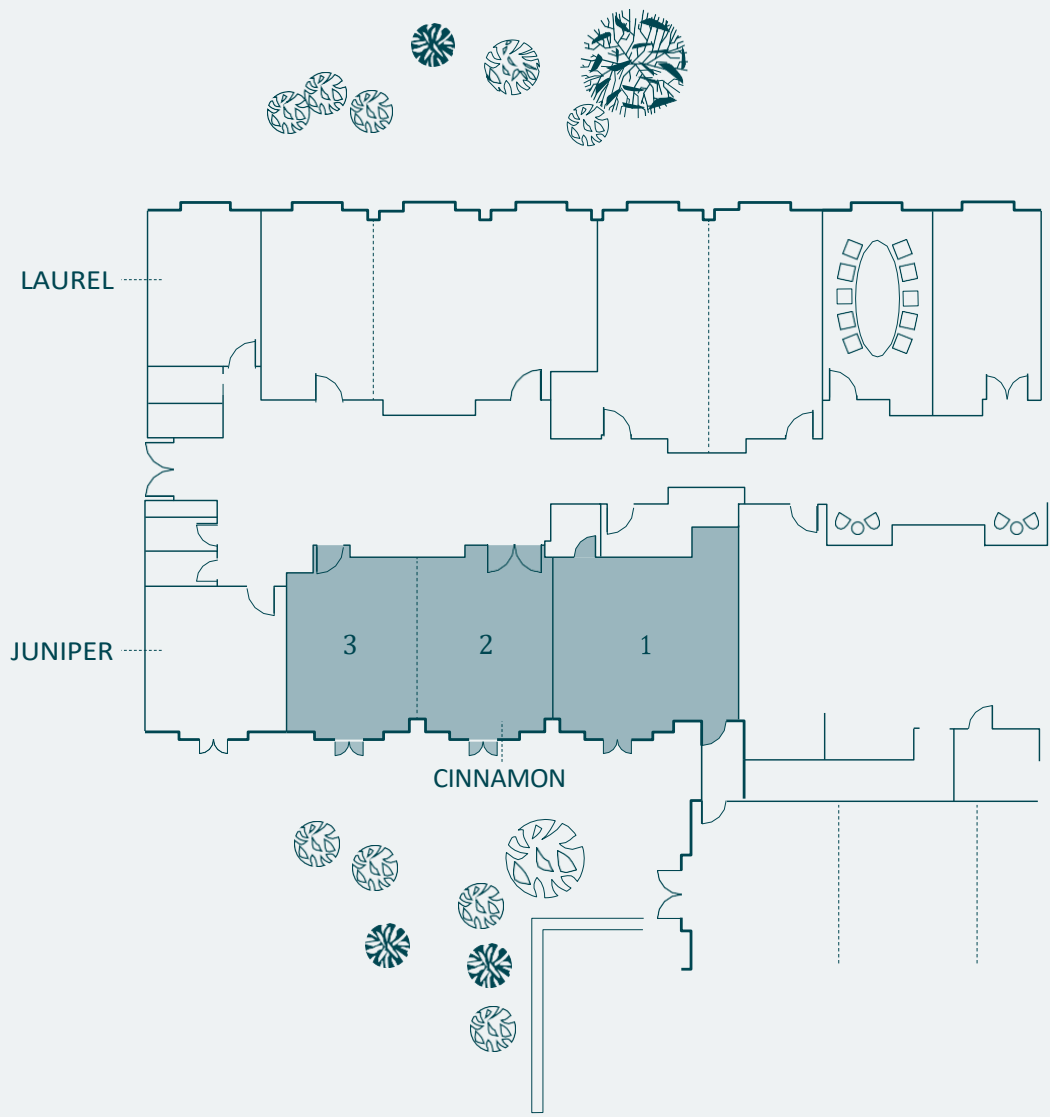

# SILK & OCHRE



The perfect partners can be used together or apart depending on your needs. Ideal for smaller conferences, presentations, board meetings, or private dining and celebrations.

## KEY FEATURES

Ground floor location

Divisible into 3 rooms

LED screen

In-built projector

Tungsten Halogen lights

In-room dimmer controls

## DIMENSIONS

	Silk	Ochre
Area	42sqm	54.72sqm
Height	2.9 to 3.4m	2.9 to 3.4m
Length	5.6m	4.8m
Width	7.5m	11.4m

## SET-UPS

Theatre	42	48
Classroom	20	30
Boardroom	16	28
U-shape	12	27
Cabaret	20	24
Reception	56	72
Lunch/Dinner	30	40
Seated buffet	20	30
Standing buffet	30	40

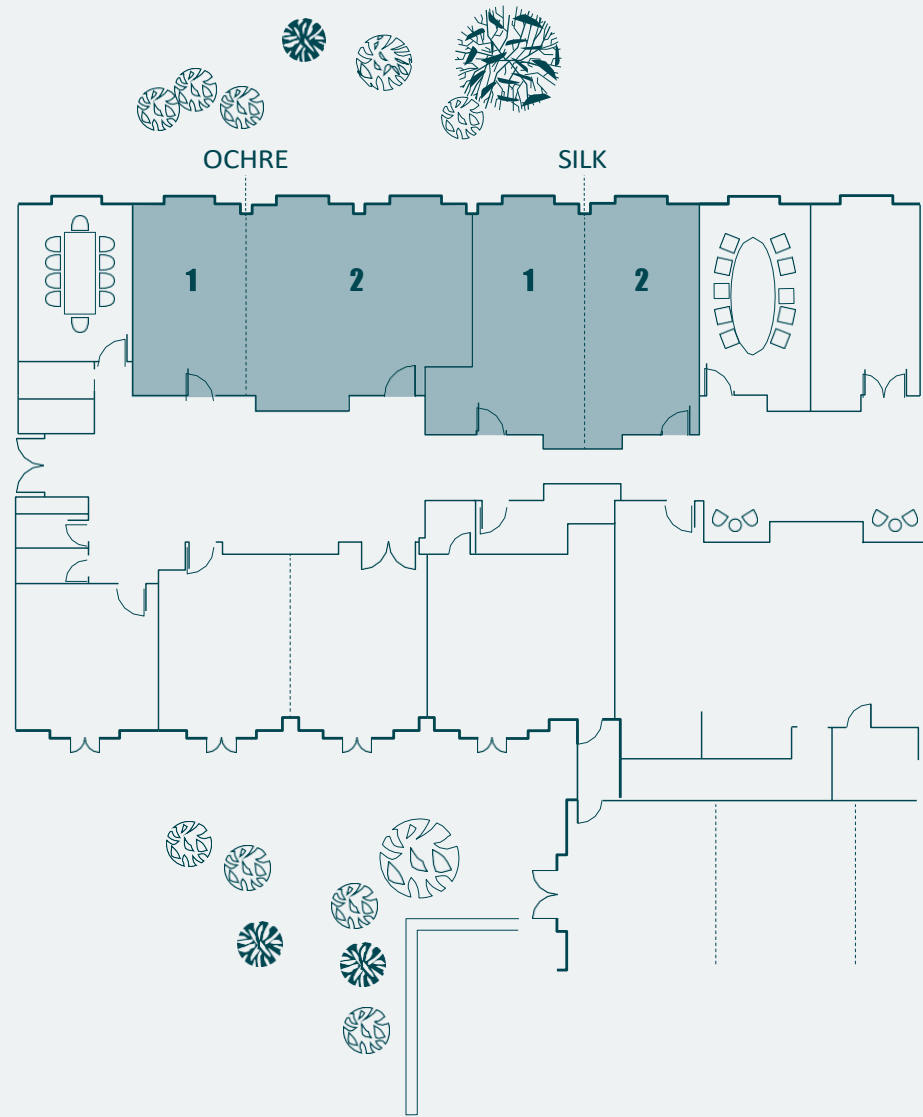

# INDIGO & IRIS



Ideally located for the Ivory Suite, these purpose built breakout spaces feature whiteboard walls, natural daylight and in room technology.

## KEY FEATURES

Ground floor location

Indigo is divisible into 2 rooms

LED screen

Wall hanging flip charts

Iris 1 and 2 have fixed boardroom tables

## DIMENSIONS

	Indigo	Iris
Area	61.37sqm	20.93sqm
Height	2.9m	2.9m
Length	7.96m	5.26m
Width	7.71m	3.98m

## SET-UPS

Theatre	50	
Classroom	24	
Boardroom	18	9
U-shape	20	
Cabaret	32	
Reception	56	
Lunch/Dinner	48	
Seated buffet	40	
Standing buffet	50	

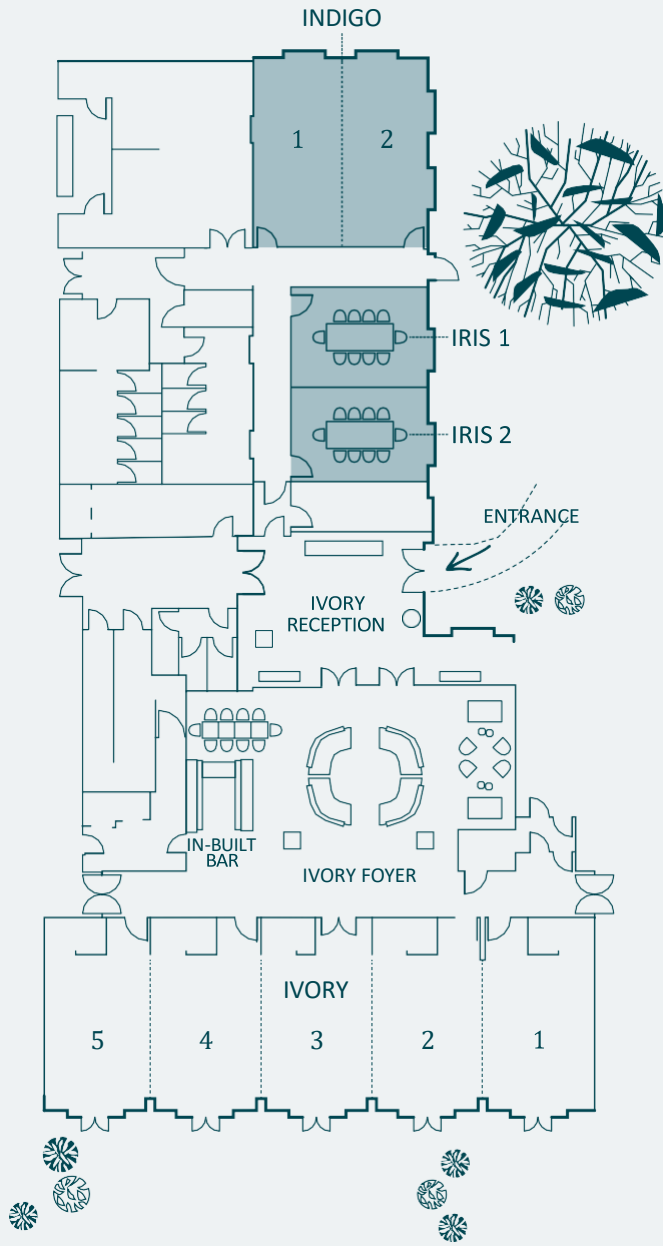

# REDWOOD & WILLOW



Bright and contemporary rooms which are located off the Cedar Foyer, ideal for office and breakout space for The Cedar Suite.

## KEY FEATURES

Ground floor location

Redwood is divisible into 2 rooms

LED screen

Whiteboard walls

Wall hanging flip charts

Willow has a fixed boardroom table

## DIMENSIONS

	Redwood	Willow
Area	43.63sqm	22.1sqm
Height	2.9m	2.9m
Length	5.66m	6.28m
Width	7.71m	3.52m

## SET-UPS

Theatre	40	
Classroom	18	
Boardroom	18	9
U-shape	18	
Cabaret	18	
Reception	40	
Lunch/Dinner	24	
Seated buffet	24	
Standing buffet	40	

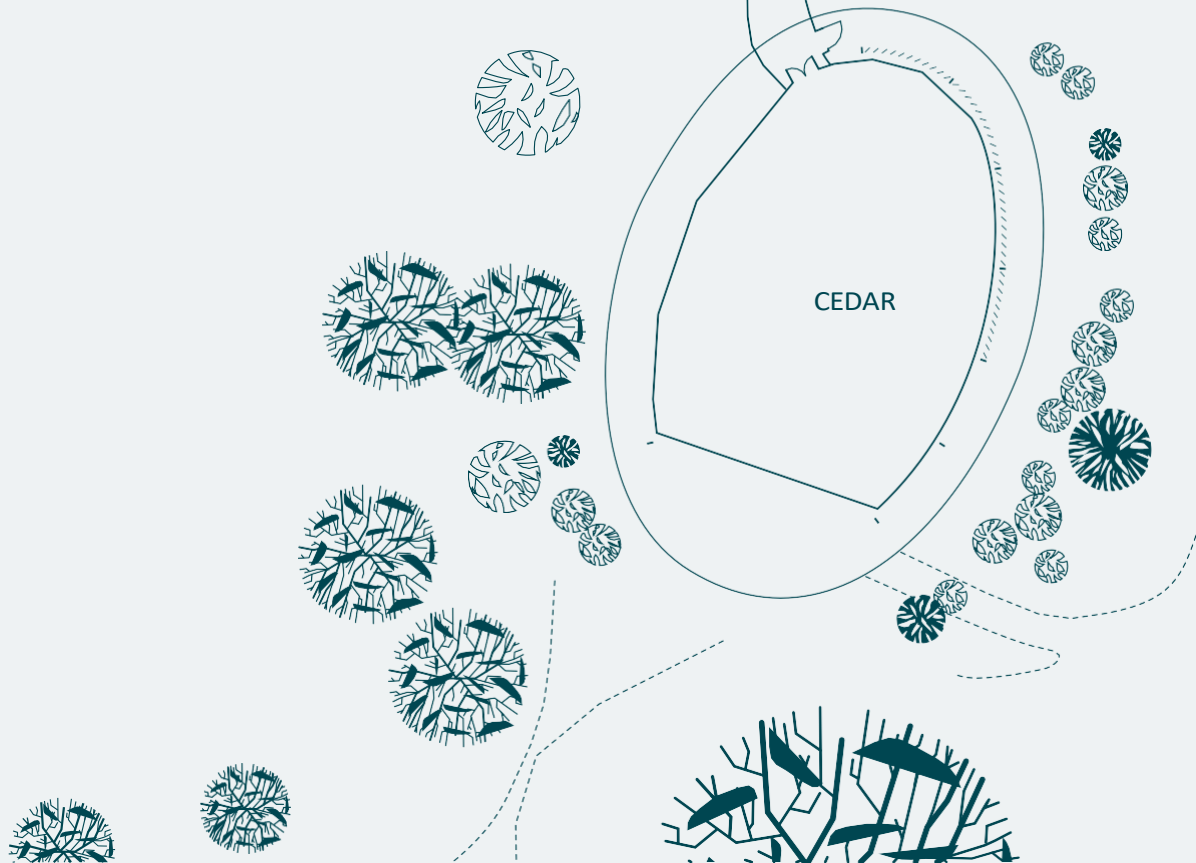
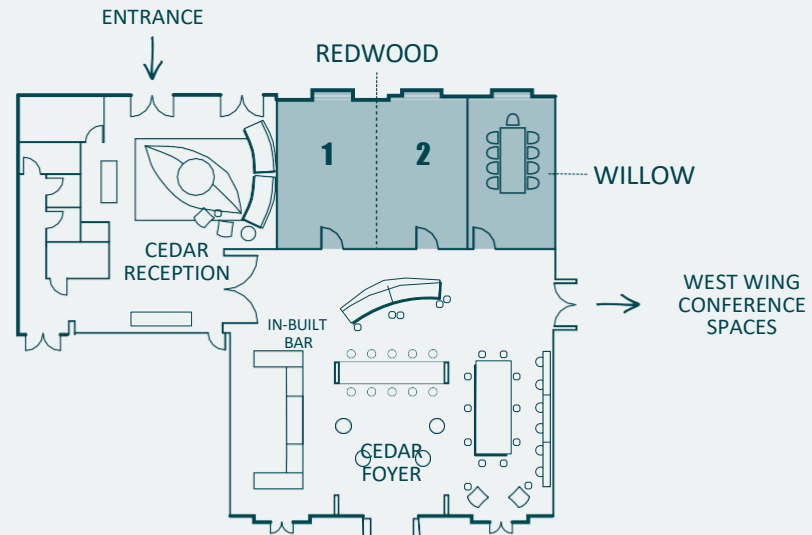

# LAUREL & JUNIPER



Two centrally located breakout spaces with lots of natural daylight and a contemporary design. With in-built LED's, these rooms are ideal for small breakout sessions.

## KEY FEATURES

Ground floor location

LED screen

Wall hanging flip charts

Juniper has a garden terrace

## DIMENSIONS

	Laurel	Juniper
Area	19.63sqm	21.7sqm
Height	2.9m	2.9mm
Length	5.41m	4.91m
Width	3.63m	4.42m

## SET-UPS

Theatre	12	12
Boardroom	10	10

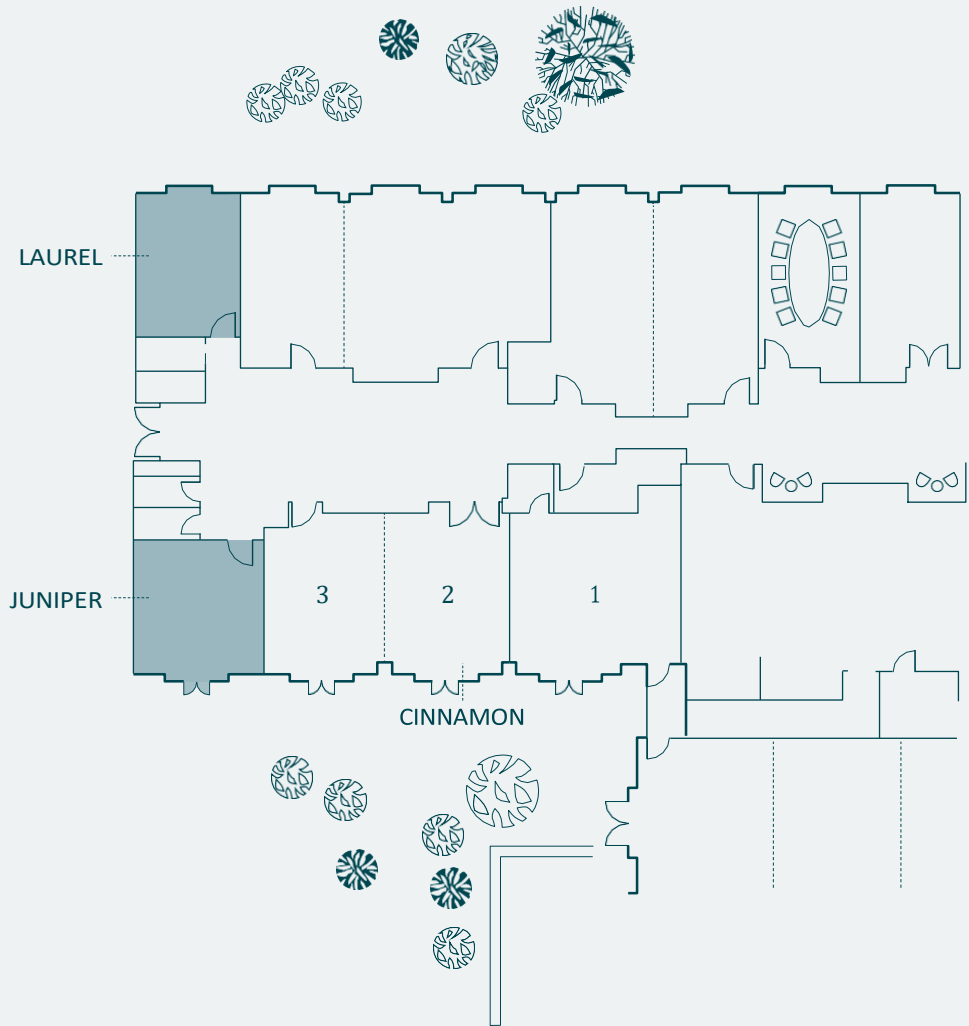

# ZEBRANO & ONYX

When you need to host a small meeting or simply escape from the larger events of the day, these bright and airy rooms offer the perfect venue for some focused meeting time.

## KEY FEATURES

Ground floor location

Onyx is accessible from Amber reception

LED screen

Whiteboard walls

Fixed boardroom tables in both Zebrano and Onyx

Tungsten Halogen lights

## DIMENSIONS

	<b>Zebrano</b>	<b>Onyx</b>
Area	19.44sqm	22.26sqm
Height	2.9m to 3.4m	2.9m
Length	5.4m	6.53m
Width	3.6m	3.41m

## SET-UPS

Boardroom	10	11
Lunch/Dinner	10	

