

HIRE HERE

at Outernet

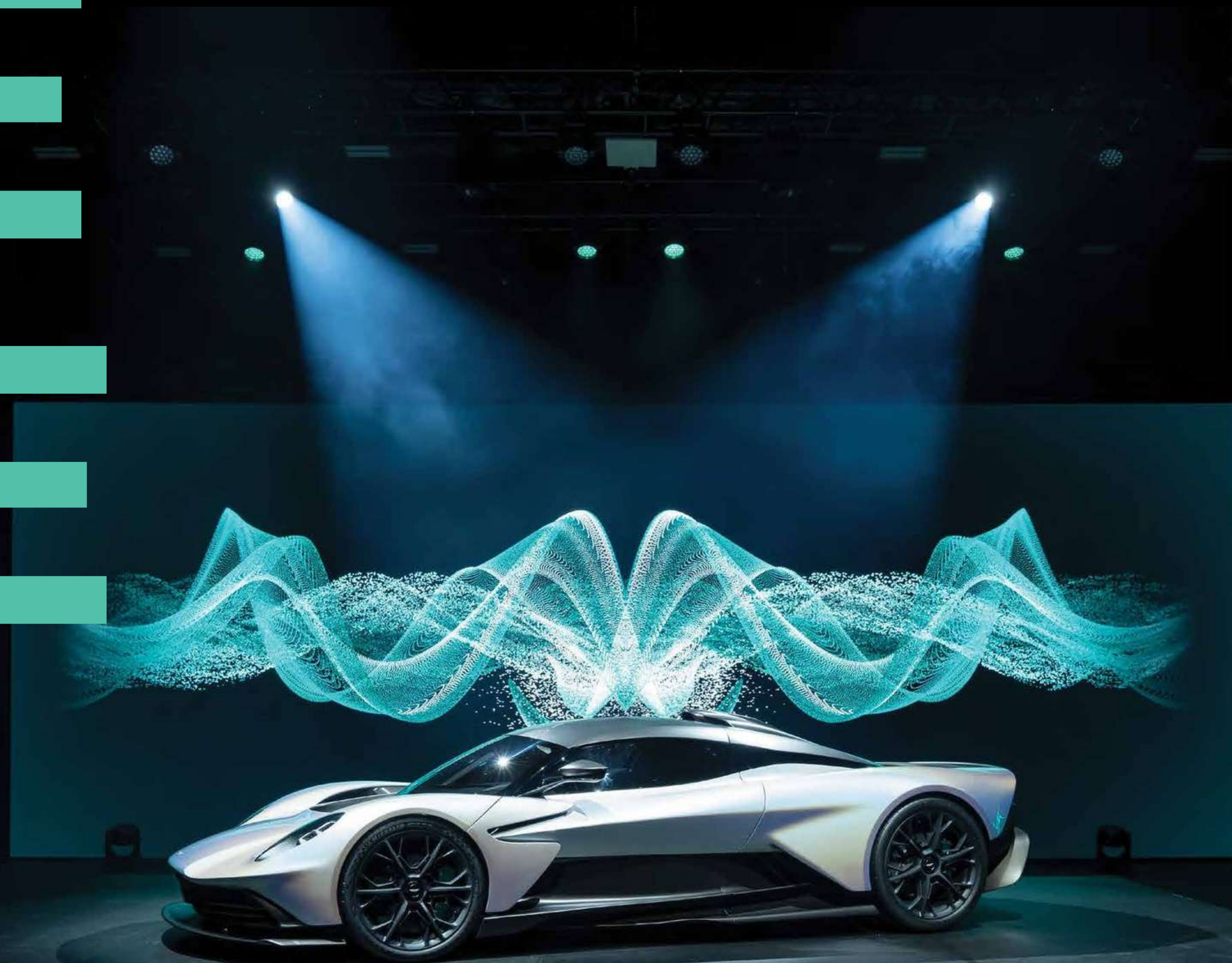

Charing Cross Rd
London, WC2H 8LH
events@outernetvenues.com

THE FUTURE OF LIVE EVENTS ENTERTAINMENT EXPERIENCES ENJOYMENT

HERE at Outernet is a feat of modern engineering, carefully crafted over a three year construction period. Every detail has been thought out. From the custom acoustic treatment, to the length and utility of the bars, everything has been designed with quality of experience in mind.

At 25,000 square feet as a district, and over 10,000 square feet HERE at Outernet, we are a blank canvas suitable for a broad spectrum of concepts. Our venue features unparalleled in-house technical equipment, from our 13.5 meter wide 6k upstage screen to our pioneering, bespoke sound system.

All this, situated right at the heart of Central London. HERE at Outernet is accessible from Tottenham Court Road station, less than 30 seconds walk to our front doors.



SPACES

MAIN SPACE



MEZZANINE



NOLO*



*additional min spend

FACILITIES



MAIN FLOOR GREEN ROOM 1



MAIN FLOOR FLEX SPACES



DIMENSIONS & CAPACITIES

Key Info

Maximum Capacity	1500
Maximum Floorspace	742 m2



Space	L(m)	W(m)	H(m)	M2	Standing	Theatre	Dinner
Main Space	24	18	–	432	1250	500	350
Mezzanine	–	–	–	200	250	–	–
Main Floor Green Room 1	–	–	–	25	–	–	–
Main Floor Flex Space 1A	–	–	–	20	–	–	–
Main Floor Flex Space 1B	–	–	–	20	–	–	–
Main Floor Cloakroom/Flex space 1C	–	–	–	45	–	–	–
Mezz Green Room 2	–	–	–	20	–	–	–



EXPLORE HERE

Level 1

- 1. The Lower Third Club Room
- 2. Main Staircase (C)
- 3. Lift Lobby

Mezzanine

- | | |
|----------------------------|-------------------------|
| 1. Void | 9. Lift Lobby |
| 2. Mezzanine Bar | 10. WC |
| 3. Cocktail Lounge | 11. WC |
| 4. Mezzanine Cloakroom | 12. Mezzanine Stair (D) |
| 5. Mezzanine Flex Space 2A | 13. Refuse |
| 6. Mezzanine Flex Space 2B | 14. Freight Lift |
| 7. Mezzanine Green Room 2 | 15. Control |
| 8. Main Staircase (C) | 16. Production Store |

Main Floor

- | | |
|-----------------------------|----------------------------|
| 1. Stage | 9. Main Floor Green Room 1 |
| 2. Kage Bar | 10. WC |
| 3. Mezzanine Overhang | 11. WC |
| 4. Light Bar | 12. Lift Lobby |
| 5. Catering Prep Space | 13. Main Staircase (C) |
| 6. Main Floor Cloakroom | 14. Mezzanine Staircase |
| 7. Main Floor Flex Space 1A | 15. Refuse |
| 8. Main Floor Flex Space 1B | 16. Freight Lift |
| | 17. Production Store |

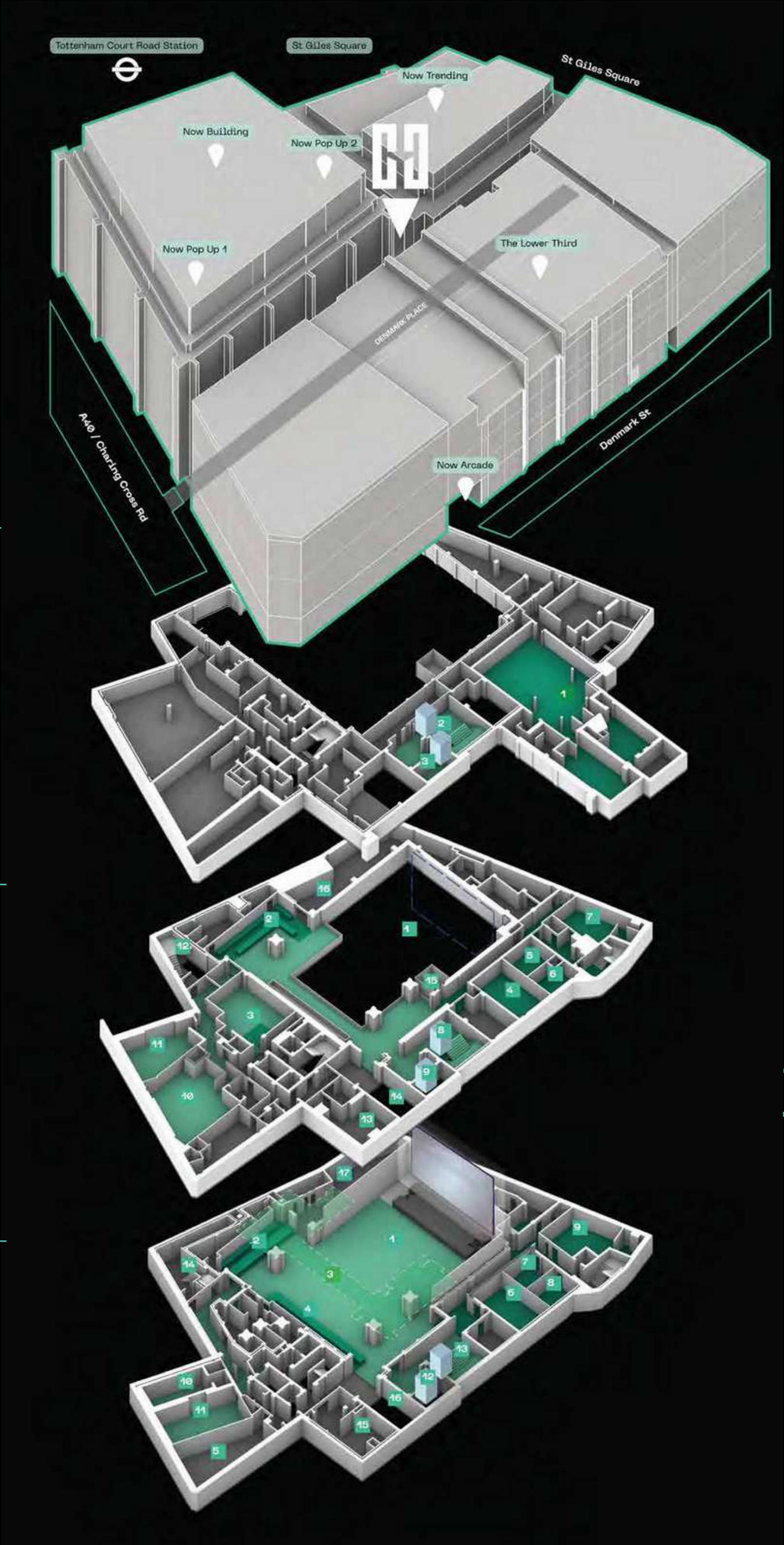

Hidden four stories under Tottenham Court Road our space comprises three unique areas which can all be activated for events. These are the Main Floor, The Mezzanine, and The Lower Third.



MAIN FLOOR FLOORPLAN

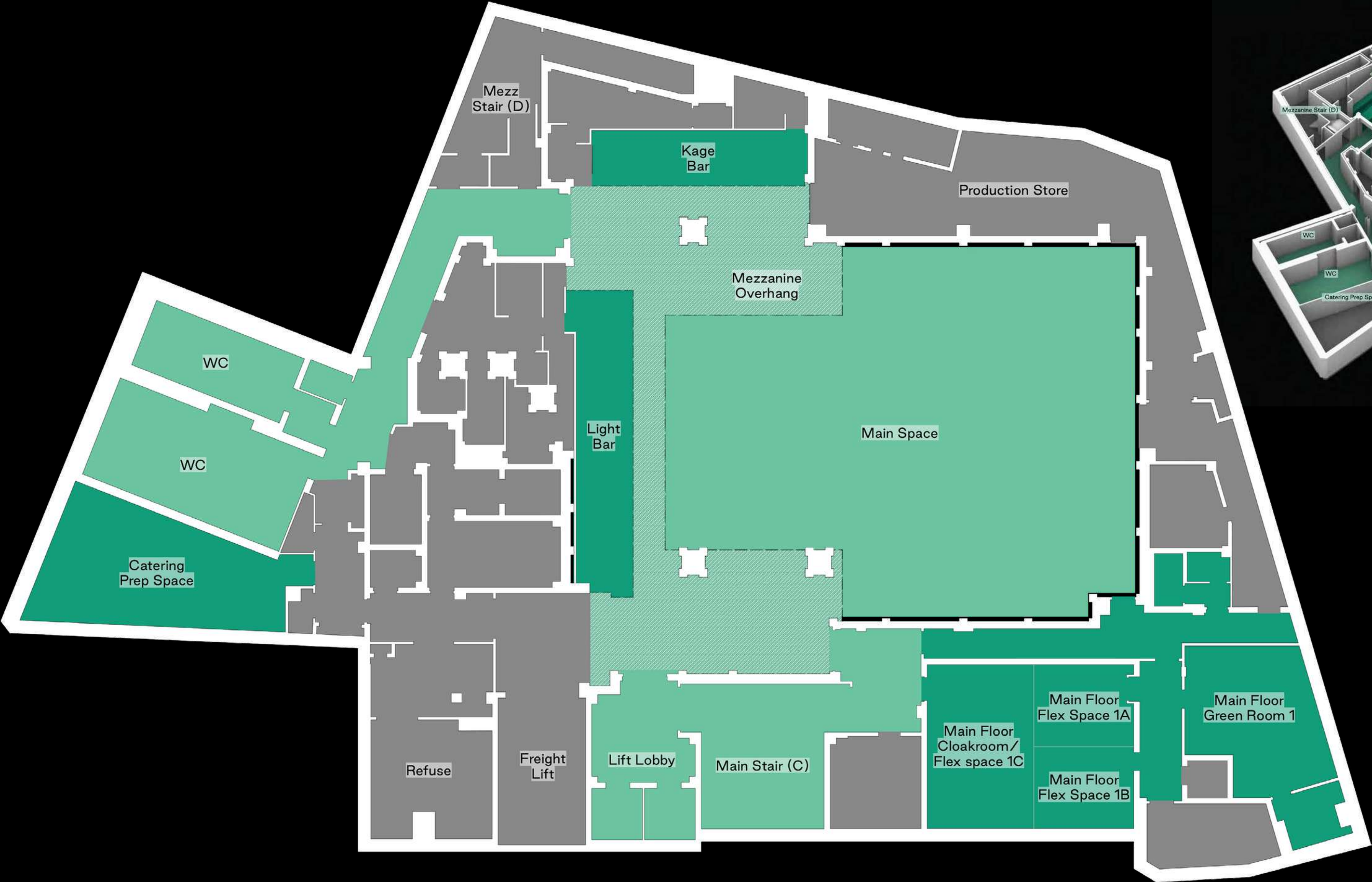

MEZZANINE FLOORPLAN

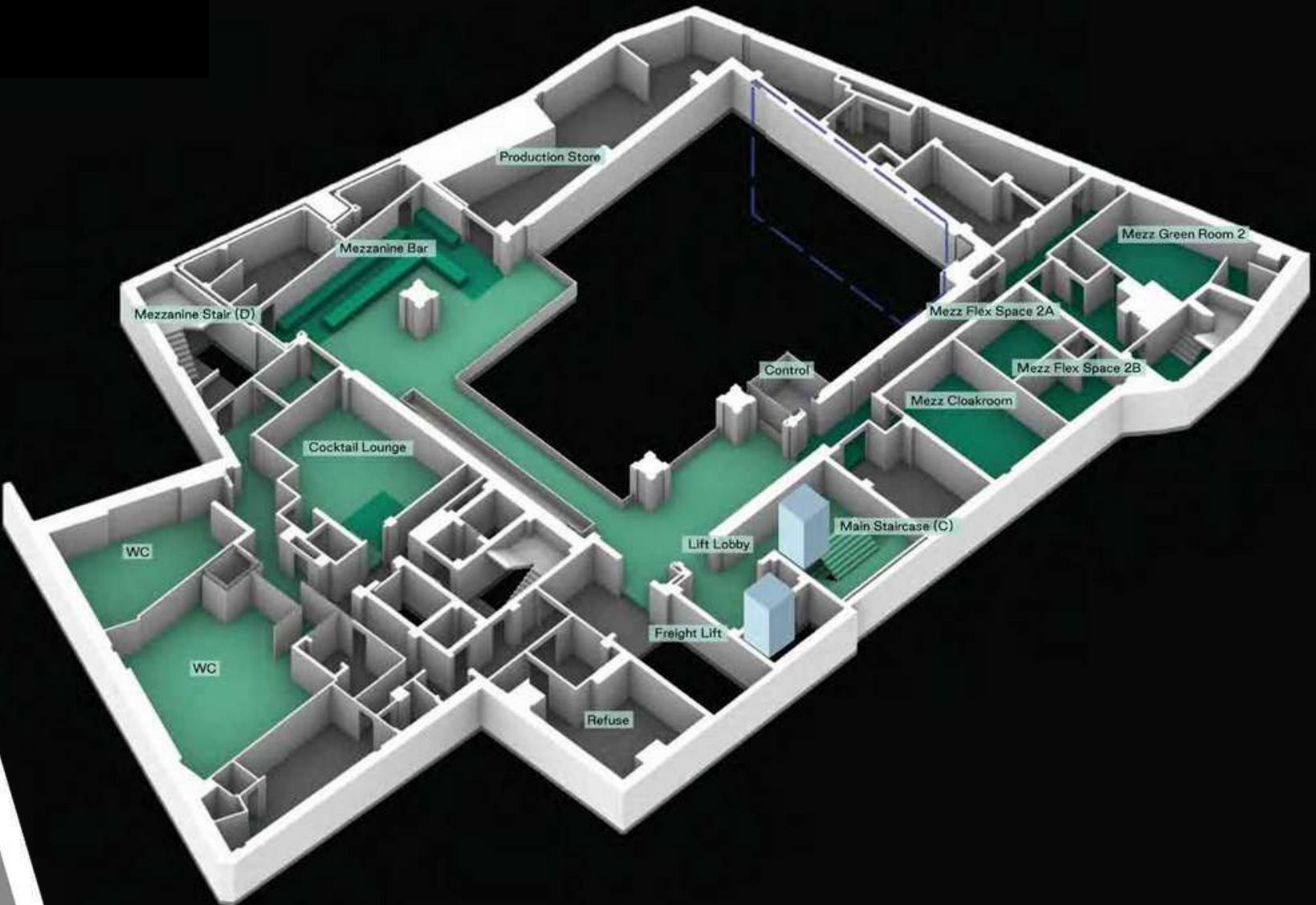

STANDING LAYOUT

Max Capacity: 1500 staging dependent

Ideal for: Large receptions, parties, performances and concerts

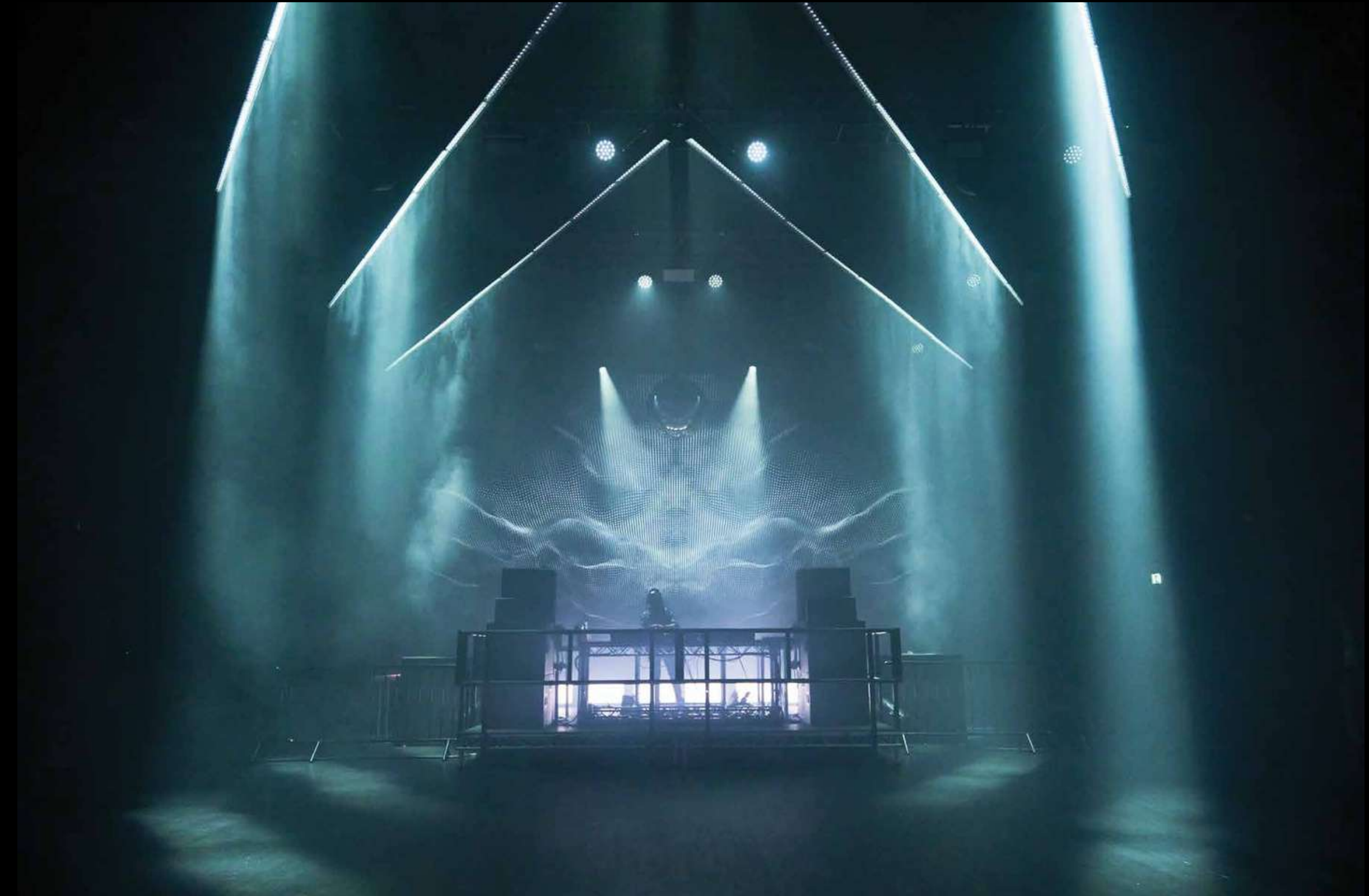
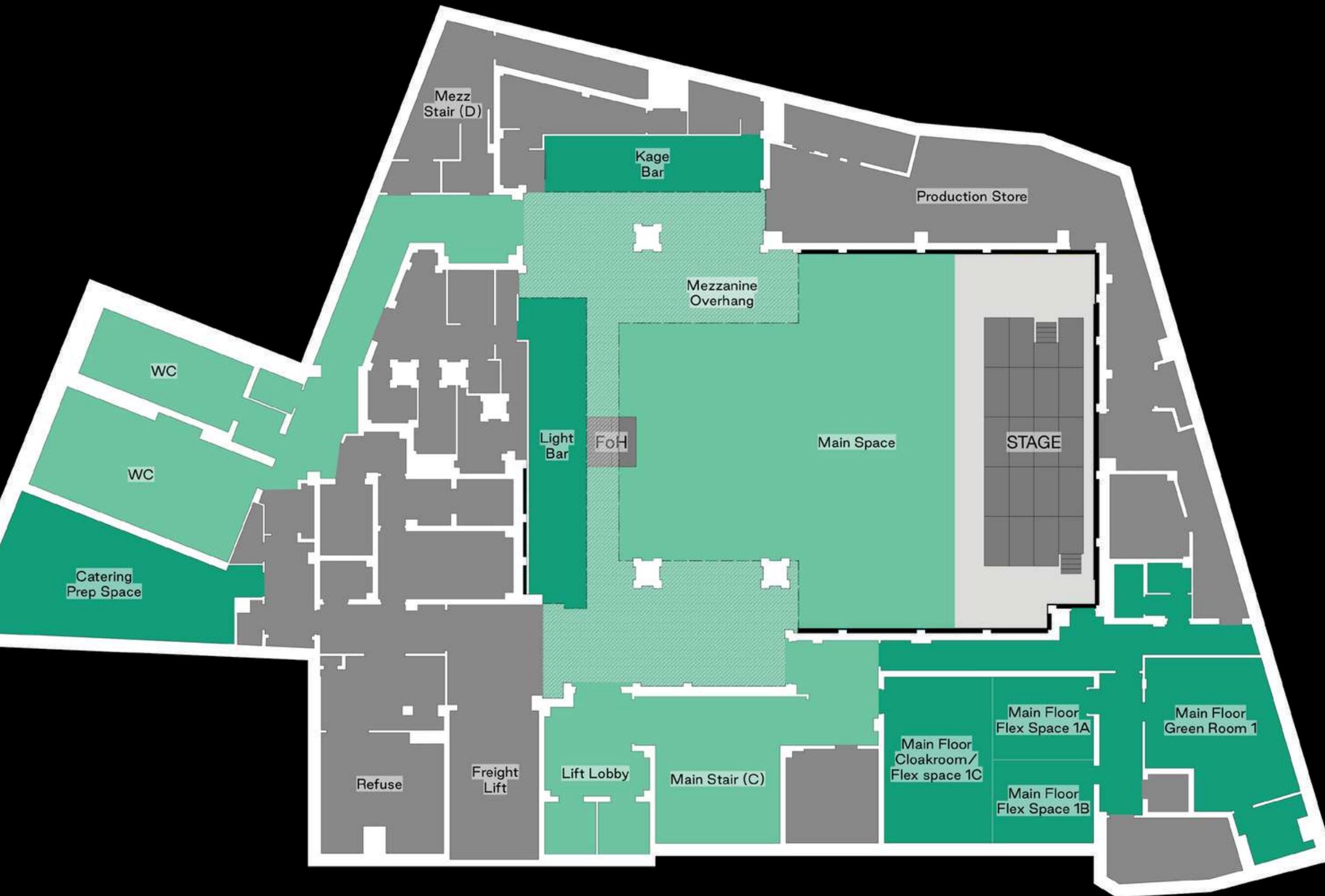

THEATRE LAYOUT

Max Capacity: 500

Ideal for: Talks, Conferences, Seated shows

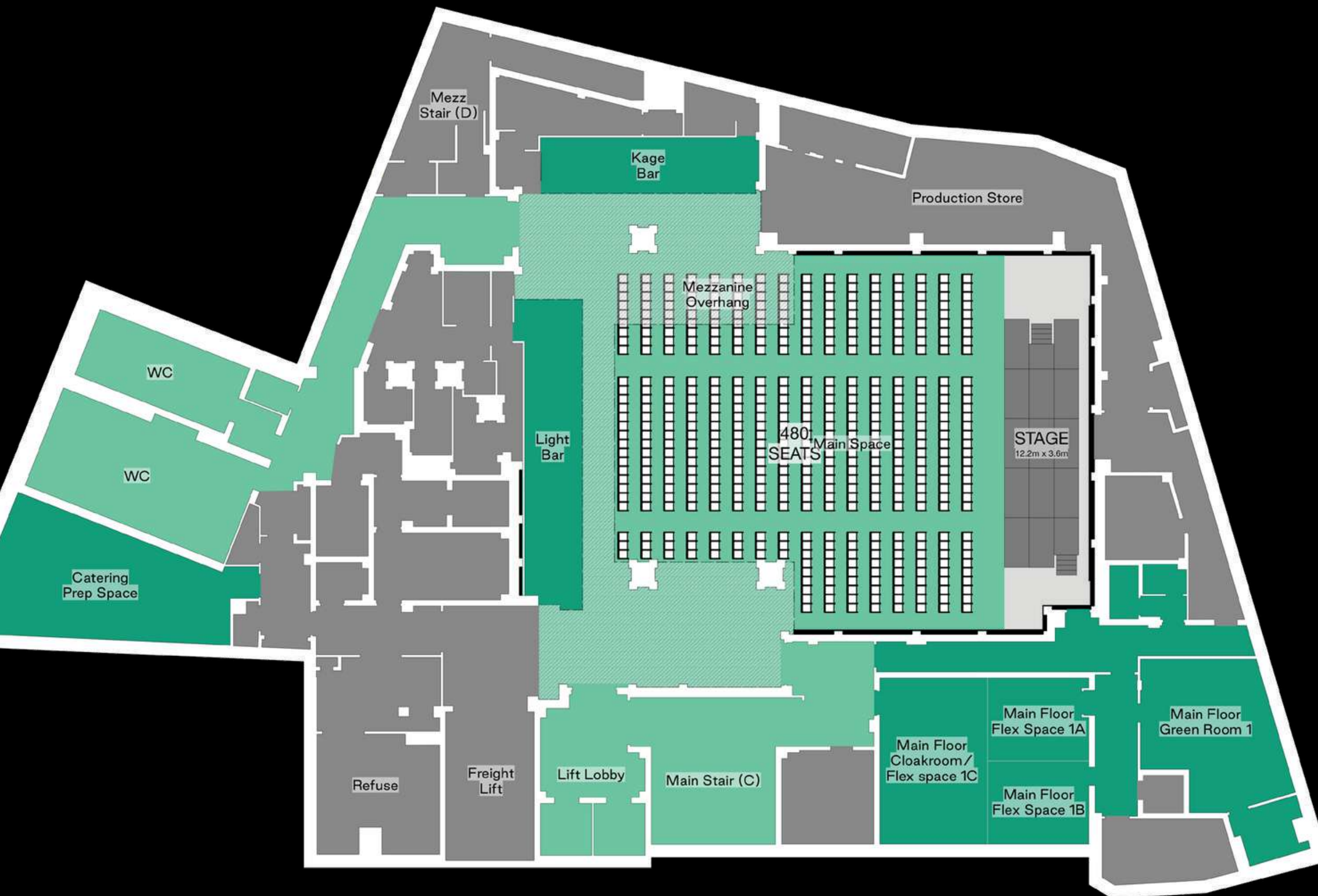

DINNER LAYOUT

Max Capacity: 350

Ideal for: Gala Dinners, Awards Ceremonies, Auctions, Cabaret style shows

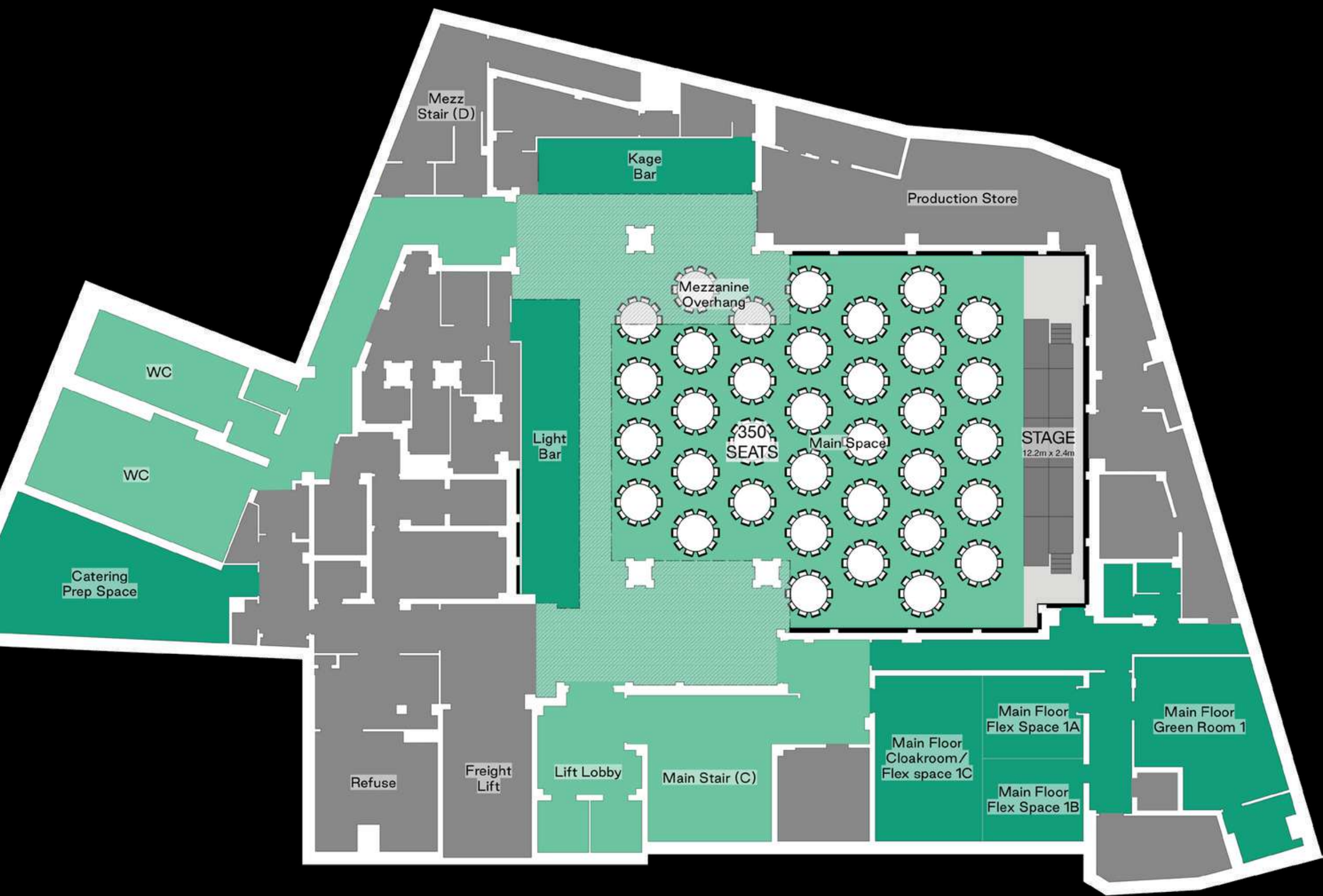

PRODUCTION

As a purpose-built venue, HERE has been modelled to include a 13.5 x 5m LED screen, state-of-the-art lighting rig, d&b sound system, and an in-house stage; with upgrades and AV packages available on request.

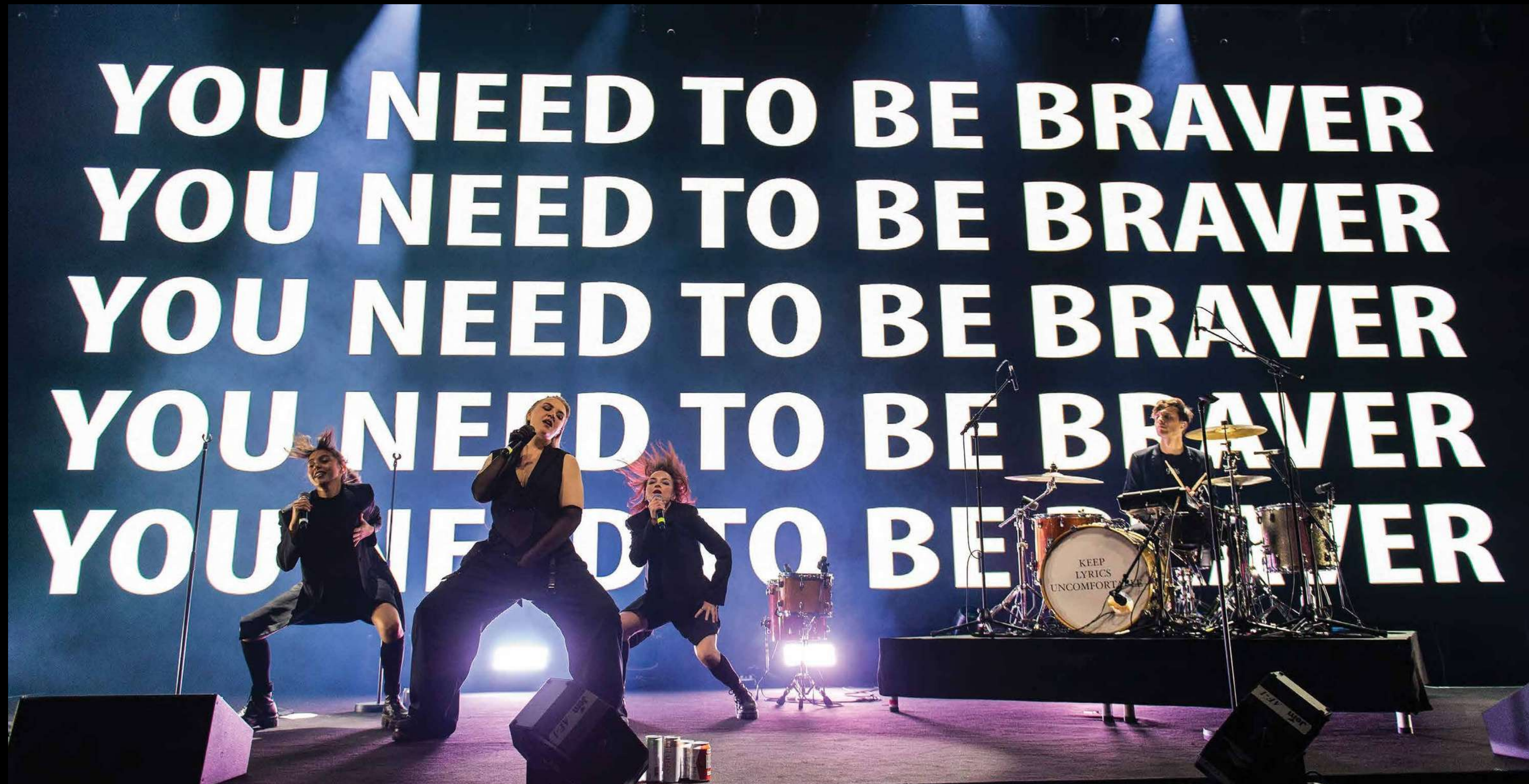

CATERING

We work with a list of preferred caterers that provide a range of creative and delicious catering concepts all serviced from our catering prep area on small or large scale events.



TECHNICAL

STAGING

There are 4 standard staging layouts, each is made from Litedeck staging and is finished with a plain black bare wood top.

- Live Performance – Stage dimensions are 12,200mm wide, 4,880mm deep at 950mm high.
- Conference – Stage dimensions are 12,200mm wide, either 2,440mm, 3,660mm or 4,880mm deep at 570mm high.
- DJ – 4,880mm x 4,880mm at 380mm high.
- No stage – All staging removed.

Each of these options is included within the venue hire fee. The optional FOH riser is 2440mm x 2440mm and 380mm high as standard. Having a FOH control position does impact the room capacity. Other configurations for the stage and FOH position are possible but may further impact capacity and will incur additional charges.

All staging is Litedeck. Additional deck is available to hire.

We can arrange hard or soft facias and carpeting for all stage layouts, please ask for a quote

RIGGING

The installed rigging system has a grid of rigging points in the roof as per the venue plans. The points are rated between 0.5 and 3 tonnes, depending on their location.

There are 7 evenly spaced lighting trusses across the space. The LED screen is on its own truss and there is a smaller truss immediately downstage of that.

All of these trusses are rigged from the 3 tonne points in the ceiling and are suspended on multiple motors.

All trusses can have their height adjusted by the in-house team but any variation, such as removing or relocating a truss, will have a cost implication.

LIGHTING

The house lighting rig has been designed as a comprehensive layout to cover live music, club and corporate events. Control is a GrandMA3 which can be used in MA2 or MA3 modes.

Lighting Fixtures

- 26 x Ayton Diablo
- 28 x Martin Mac Aura
- 24 x GLP JDC1 LED Wash & Strobe
- 1 x MDG ATme Hazer with DMX Fan
- 1 x Unique2 Hazer with DMX Fan (incurs additional charge)

We can add to or edit the lighting rig as required, but this will incur a labour fee for changes and a hire cost for additional equipment.

TECHNICAL (CONT.)

AUDIO

The house audio system is a strong, powerful and high quality d&b PA with DigiCo Quantum 225 consoles, both FOH and monitor position.

- Line Array
 - 10 x d&b XSL8
 - 4 x d&b XSL12
 - (7 boxes per side)
- Subs
 - 5 x d&b SL-GSUB
- Fills
 - Front – 2 x d&b V7P
 - Mezzanine – 2 x d&b Y10P
 - Rear – 2 x d&b Y10P
- Monitors
 - Wedges – 10 x d&b M4
 - Drum sub – 1 x d&b B6
 - Sidefills – 2 x d&b V7P and 4 x d&b V-GSUB

We have a comprehensive stock of Sennheiser and Shure microphones, DI boxes and stands.

- RF System
 - 2 x Sennheiser SKM6000 Handheld Transmitter with MM435 Capsule
 - 2 x Sennheiser SK6000 Bodypack Transmitter
 - 4 x Sennheiser EK G4 Receiver (IEMs)

VIDEO & SCREENS

The Video Gallery is located back of house on the mezzanine level of the HERE venue, adjacent to our engineering event comms room. We can also facilitate a larger gallery in the flexi space at stage level (depending on availability).

There are multiple screens within the venue:

Stage Screen

Size: 13,500mm wide x 5,000mm high
(can sit on the floor or up to 1,500mm above the floor)

Resolution: 5184 x 1920 pixels

Aspect Ratio: 2.7:1

Staircase Screen

Size: 5,000mm wide x 3,000mm high

Resolution: 1,920 x 1,152 pixels

Aspect Ratio: 5:3

Additional Screens

6 x 55” 2K screens on pillars
(3 on each level in the main room)
1 x 75” 2K screen in the VIP bar.

2 x 55” 2K screens on unicol stands available
for hire for use throughout the venue.

Cameras

3 x Panasonic AWRP150 PTZ
Cameras located on the front of the mezzanine

Engineering

3 x Blackmagic Hyperdeck 4K Pro

1 x 40x40 12G SDI Matrix

1 x Tascam Tri-level Sync Masterclock

Playback

1 x Disguise GX3 Media Server with NDI, 12G SDI and HDMI low-latency inputs.
If a backup server is required, this can be provided for a charge.

Gallery

1 x Panasonic AWRP150 Camera Controller

2 x Mac Pro for playback with Keynote, PPT, Playback Pro

The LED and Pillar Screens are included in the hire with the Media Server to operate them for basic video playback.

The video gallery, its equipment, and the PTZ cameras are chargeable extras.

LOCATION

HERE at Outernet is situated in the heart of Central London, less than one minute walking distance from exit 4 of Tottenham Court Road Station. 15 mins from Oxford St and 10 mins from Covent Garden.

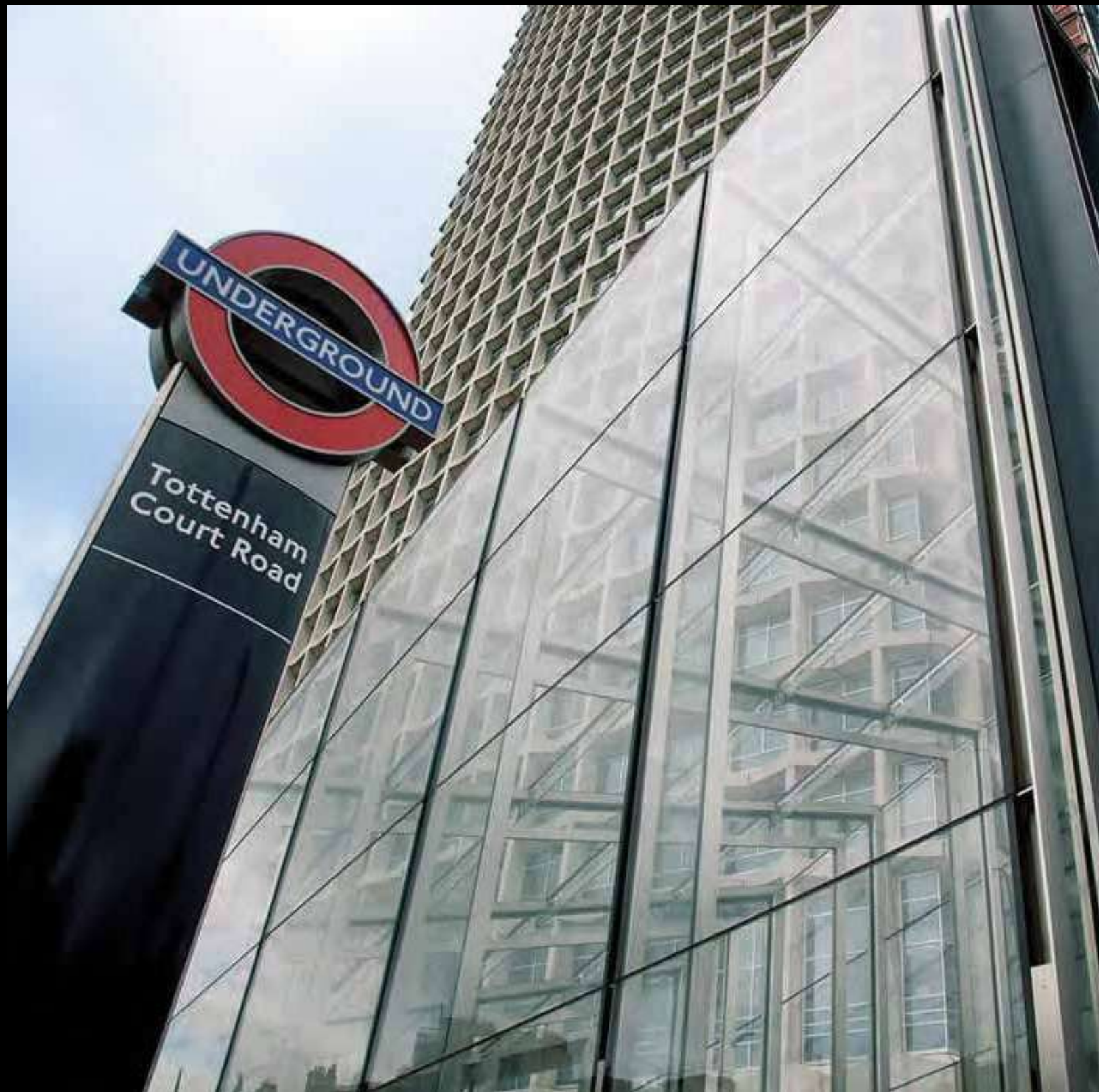

OUTERNET DISTRICT

We are proudly part of the Outernet district, London's newest entertainment and hospitality destination. The centre of the district is brought to life by a collection of multimedia screens which can be activated as part of any event dependent on budget and availability.

Additional amenities include Chateau Denmark with 55 luxurious rooms, Asian fusion restaurant Tattu, and Mediterranean cuisine from Cavo.

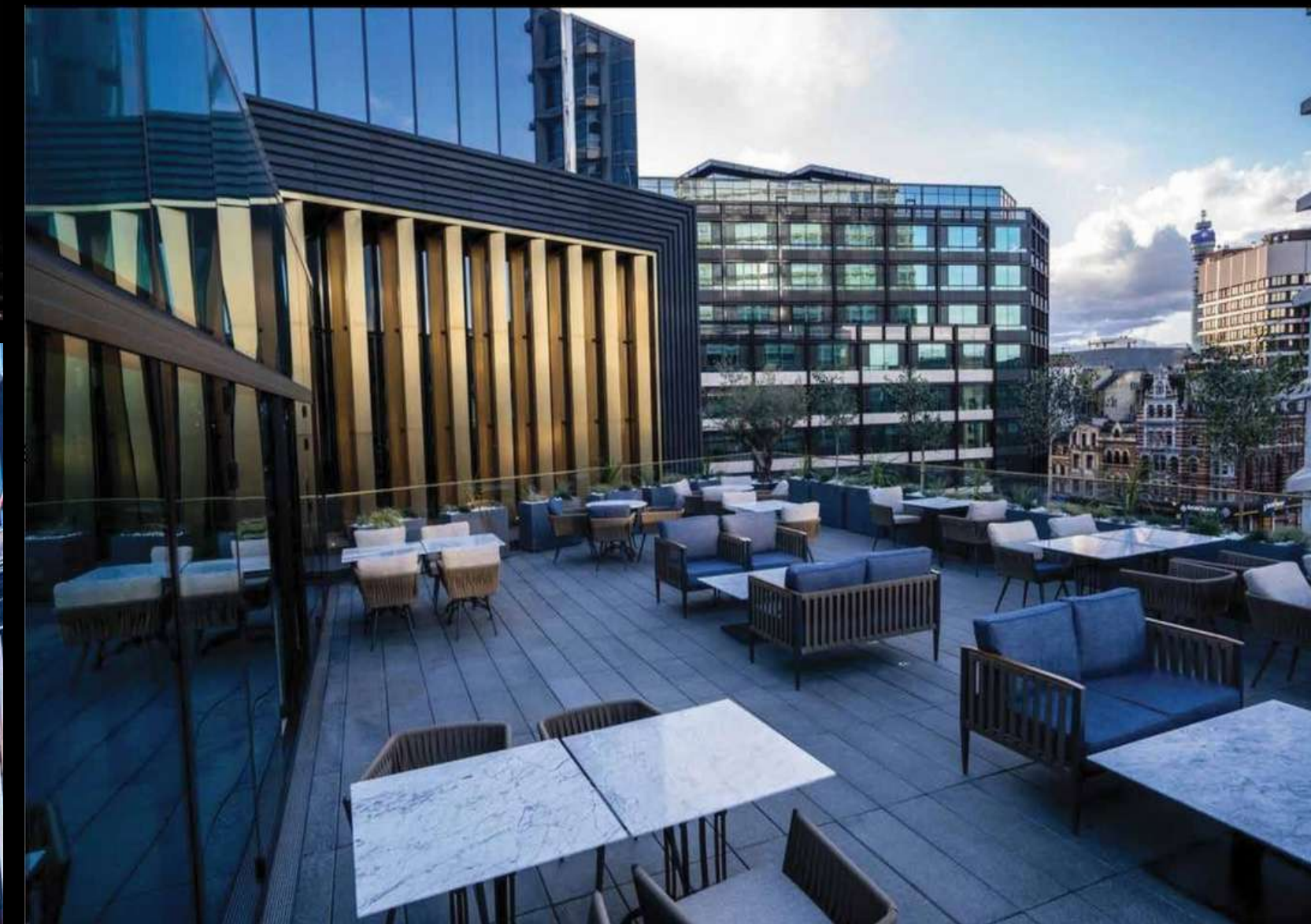

GET IN TOUCH

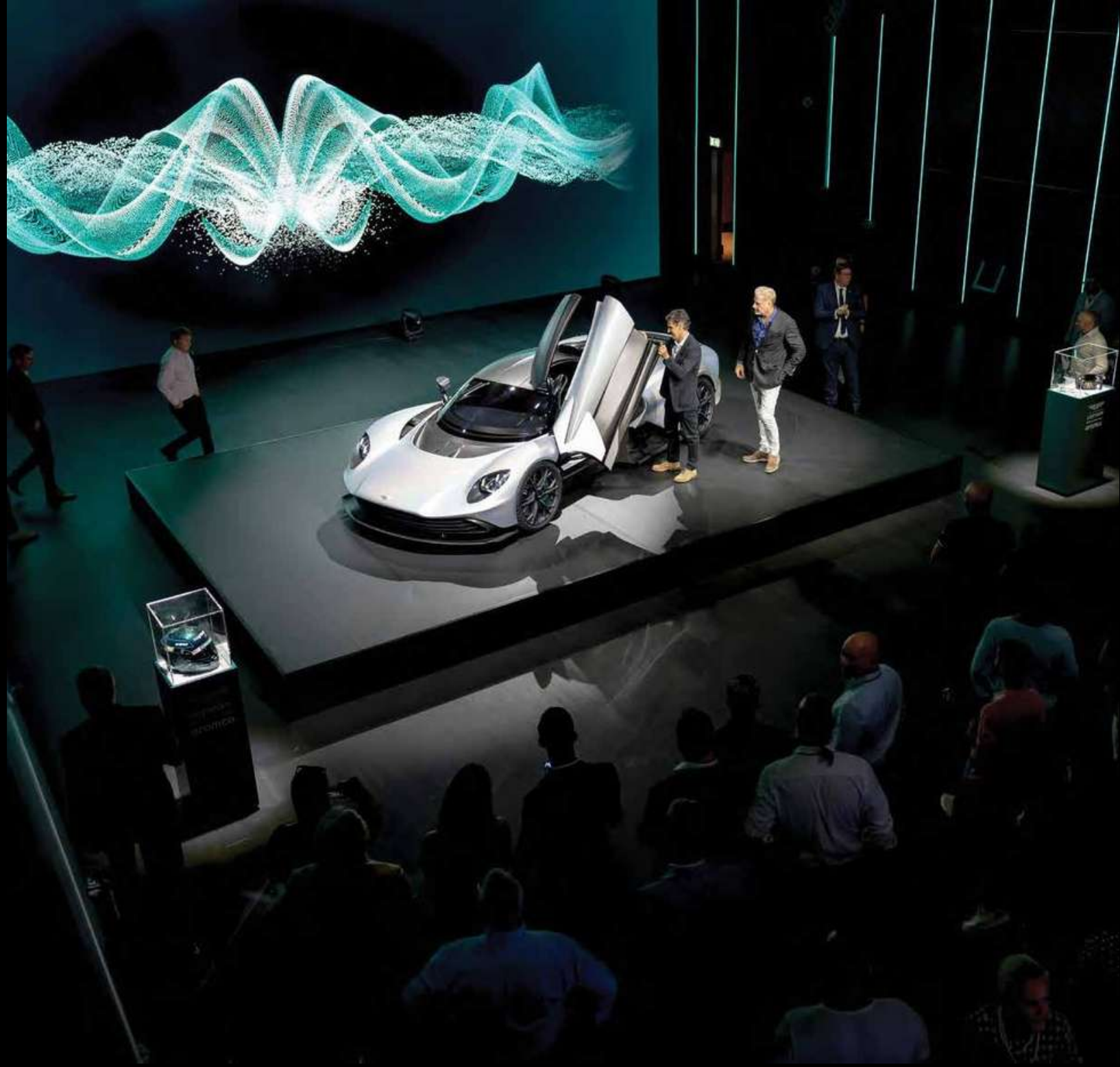

events@outernetvenues.com

HERE at Outernet
Charing Cross Rd
London, WC2H 8LH

